

# Excellence Through EQUITY

Region II



*2nd Annual*

## Excellence Through EQUITY Conference



It is with great pleasure that I welcome you to the *2nd Annual Region II Excellence Through Equity Conference*. Chesapeake Public Schools is extremely honored to serve as the hosting school division for this important and exciting event.

This conference is an opportunity for local, regional, and national school leaders to work together in the pursuit of equity for all students. The goal of this conference is to offer educational leaders an opportunity to deepen their understanding of equity and make it a reality for all students.

You are among more than 800 administrators across Hampton Roads that are seeking to create and inspire equitable and inclusive educational opportunities for all children. I am extremely proud of the work that we are doing as a region to ensure that our children receive the best education possible.

Best wishes and enjoy the conference,

***James T. Roberts***  
**Superintendent**  
**Chesapeake Public Schools**

### *Conference Goals*

**Goal 1:** Share evidence-based best practices and approaches to equity that can be replicated in schools and divisions throughout our region.

**Goal 2:** Develop a foundation for building effective relationships based on self-awareness and the lived experiences of others furthering a culture of *Excellence Through Equity*.

**Goal 3:** Acquire and be ready to utilize resources, a process, and shared experiences from a network of educators focused on creating a culture of *Excellence Through Equity*.

### **Participating School Divisions**

Chesapeake Public Schools  
Newport News Public Schools  
Norfolk Public Schools  
Portsmouth Public Schools  
Poquoson Public Schools  
Suffolk Public Schools  
Virginia Beach Public Schools  
Williamsburg/James City County Public Schools  
York County School Division

# CONFERENCE AT A GLANCE



*2<sup>nd</sup> Annual Region II*

## ***Excellence Through EQUITY Conference***

August 1, 2017



Western Branch High School

Below is a snapshot of the overall conference schedule. Please refer to your personalized schedule that will be provided during registration on the day of the conference.

| Session Time   | Event  | Location                         |
|--|--|----------------------------------|
| 8 a.m.-8:45 a.m.   | Registration and Continental Breakfast   | Cafeteria                        |
| 9 a.m.-10:30 a.m.  | Opening Session<br><i>Keynote Speaker: Dr. Pedro Noguera</i>   | Auditorium                       |
| 10:45 a.m.-11:45 a.m.                                      | Breakout Session 1   | Determined by breakout selection |
| <b><i>ELEMENTARY AND CENTRAL OFFICE ADMINISTRATORS</i></b> |  |                                  |
| 12 p.m.-12:30 p.m.   | Lunch  | Cafeteria                        |
| 12:45 p.m.-1:15 p.m.                                       | Inspirational Message 2-A (after lunch)<br><i>Keynote Speakers:<br/>Mr. Alan Blankstein and Dr. Sheli Porter</i> | Auditorium                       |
| 1:30 p.m.-2:30 p.m.  | Breakout Session 2-A   | Determined by breakout selection |
| <b><i>MIDDLE AND HIGH SCHOOL ADMINISTRATORS</i></b>        |  |                                  |
| 12 p.m.-1 p.m.   | Breakout Session 2-B   | Determined by breakout selection |
| 1:15 p.m.-1:45 p.m.  | Lunch  | Cafeteria                        |
| 2 p.m.-2:30 p.m.   | Inspirational Message 2-B (after lunch)<br><i>Keynote Speakers:<br/>Mr. Alan Blankstein and Dr. Sheli Porter</i> | Auditorium                       |
| 2:45 p.m.-3:45 p.m.  | Breakout Session 3   | Determined by breakout selection |
| 4 p.m.-4:30 p.m.   | Closing Session<br><i>Keynote Speaker: Dr. Billy Cannaday</i>  | Auditorium                       |
| 4:30 p.m.  | Ice Cream Social<br>(Sponsored by The George Washington University)  | Cafeteria                        |

# TIPS for a Successful Conference

## General Information

**PARKING** – Guests from other divisions will receive priority parking at Western Branch High School. Chesapeake Public Schools employees are asked to park in the overflow parking available at Western Branch Primary School, Western Branch Intermediate School, or Western Branch Middle School. Shuttle services will be available between the overflow parking areas and the conference venue throughout the conference.

**CONFERENCE REGISTRATION** – Please enter through the auditorium entrance of the school building. All participants should check in at their respective division’s registration table between 8 a.m.-8:45 a.m.

**CONFERENCE PRESENTERS** – All conference presenters are asked to check in at the Presenter Registration table located at the cafeteria entrance of Western Branch High School to receive important conference information. Please email all handouts and presentations to Dr. Sheli Porter at [sheli.porter@cpschools.com](mailto:sheli.porter@cpschools.com).

**NAME BADGE** – During check-in, each participant will receive an envelope with a copy of his/her *personalized conference schedule* printed on the outside of the envelope. Inside the envelope will be the participant’s badge, the *Conference at a Glance* outline, and a map of the school denoting the breakout session locations. Please wear your name tag at all times. This will be your entry ticket to all conference sessions and meals. In the event that you lose your conference schedule envelope, please report to your division’s registration table to receive a duplicate copy.

**WI-FI** – To access the Wi-Fi, use network **Ch3s\_Conf**. Password not required.

**TWITTER CHAT** – You don’t want to miss this! In preparation for a successful conference experience, please plan to join us on **Tuesday, July 25, 2017, at 7 p.m.** Use the hashtag name **#R2Equity** to be part of this networking opportunity!

**SOCIAL MEDIA** – Don’t stop the tweets! During the conference, make sure you are tweeting from your sessions to keep all participants informed on what you are learning and what is happening at the conference. Use **#R2Equity** to tell us what great ideas you are getting to take back to your division.

**MEALS** – A continental breakfast will be provided prior to the Opening Session in the school cafeteria. Participants will also receive a boxed lunch during their scheduled lunch break. A vegetarian option is available upon verbal request. Complimentary bottles of water will be available for participants between sessions. The lunch schedules have been strategically assigned to allow school leaders to network with colleagues at similar school levels. Check your conference schedule for your assigned lunch time.

**PRESENTER HANDOUTS** – All presenter handouts and presentation slides will be posted and available for download no later than August 10<sup>th</sup> at <http://www.vbcpsblogs.com/equity/>.

**CONFERENCE EVALUATION** – To assist us in evaluating your conference experience, please take time to complete the electronic survey that will be emailed by a representative from The George Washington University immediately following the conference.

# PRESENTERS

Alan Blankstein, Co-author, *Excellence Through Equity*  
Dr. Pedro Noguera, Co-author, *Excellence Through Equity*

## **ASCD**

Edwin Javius  
Dr. Vernita Mayfield

## **Beginnings Family Enrichment, LLC**

Monique Williams

## **Eastern Mennonite University**

Dr. Katherine Evans

## **Chesapeake Public Schools**

Andrea Barnett  
Kinyatta Garrett  
Melissa Goodwin  
Dr. Anita James  
Dr. Stephanie Johnson  
Dr. Dalphine Joppy  
Jahkari Taylor  
Diane Watkins  
Dr. Donna Weingand  
Dr. Leslie Wiggins

## **Suffolk Public Schools**

Gail Barker  
Dr. John Hodges

## **SCHEV/GEAR UP**

Marinna Abraham  
Reshaud Rich  
Paula Robinson  
Linda Staylor

## **Virginia Beach City Public Schools**

Dr. Thomas Ferrell, Jr.  
Dr. Paulette France  
Samaria Joyner  
Dr. Lorena Kelly  
Dr. Kellie Mason  
Dr. LaQuiche Parrott  
Dr. Donald Robertson  
Isabel Sawyer

## **Williamsburg/James City County Public Schools**

Stephanie Bourgeois  
Dr. Jeffrey Carroll  
Anne Neve  
Allison Sheppard

# Building Map

## Western Branch High School

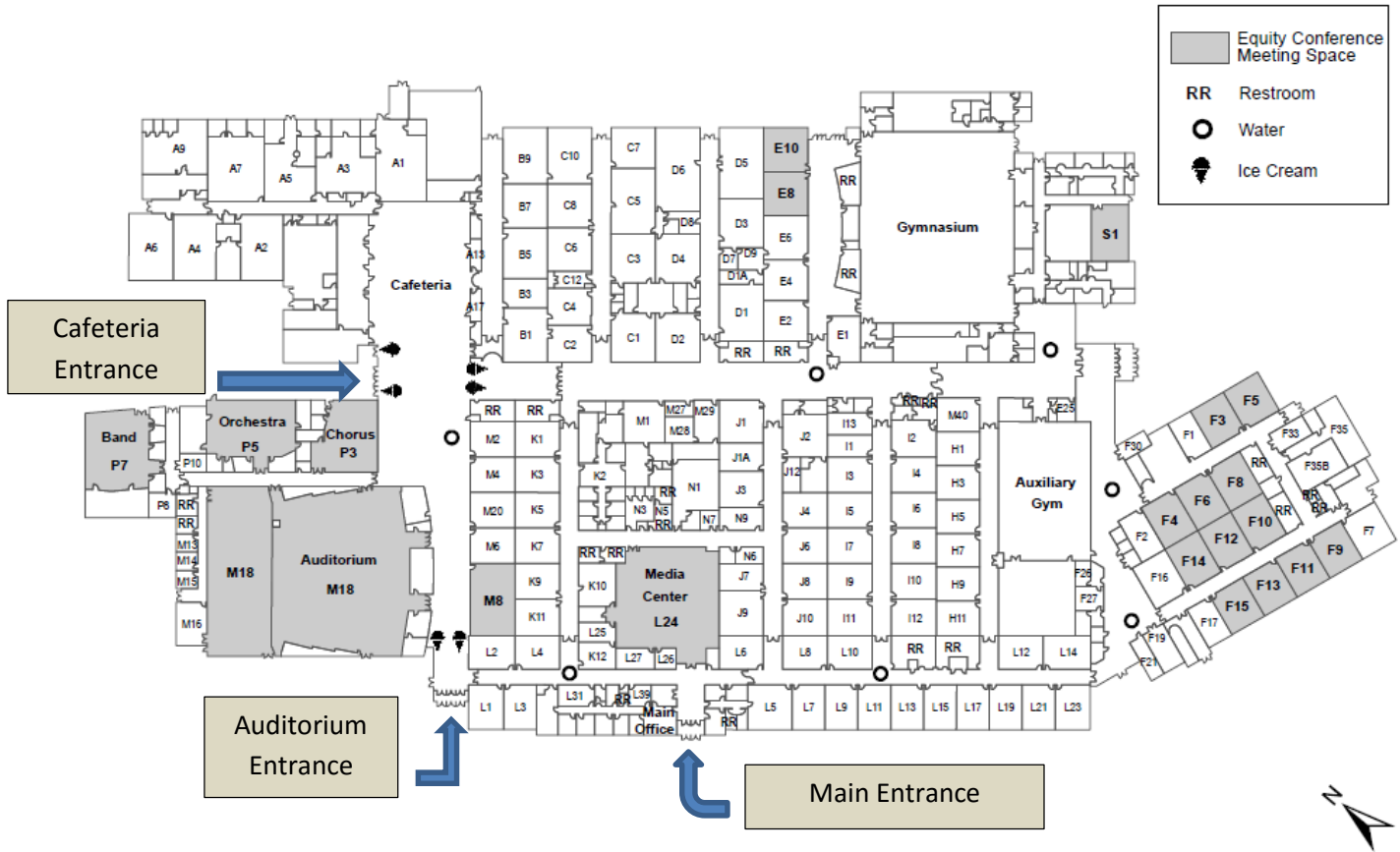

# Thank you to our conference sponsors

